

# Antwerpen

Luithagen, Haven 2



WAREHOUSE FOR RENT ↗ WAREHOUSE FOR RENT ↗ WAREHOUSE FOR

## Unit B

Warehouse **2.000 m<sup>2</sup>**

Office **250 m<sup>2</sup>**

## Unit G

Warehouse **1.000 m<sup>2</sup>**

Office **225 m<sup>2</sup>**

**AVAILABLE NOW ↗**

GROWTH ↗ SPACE FOR GROWTH ↗





## Warehouse + office

Luithagen

**Strategically located in the Port of Antwerp, this multi-tenant logistics site offers prime access and operational flexibility.**

**Unit B and G** offer a combination of high-quality warehouse space and newly renovated offices (renovation ongoing). The unit is well-suited for logistics operators looking for an efficient, connected, and future-ready base.

### Luithagen

#### Unit B

Warehouse **2.000 m<sup>2</sup>**

Office **250 m<sup>2</sup>**

#### Unit G

Warehouse **1.000 m<sup>2</sup>**

Office **225 m<sup>2</sup>**



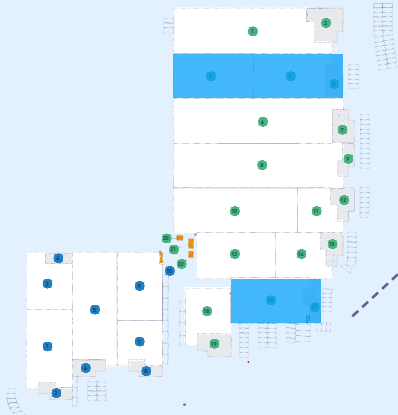
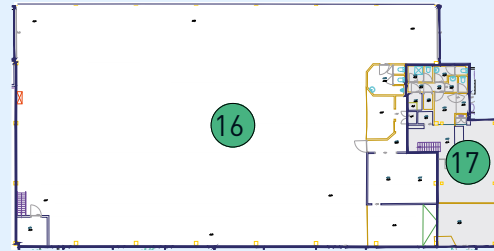
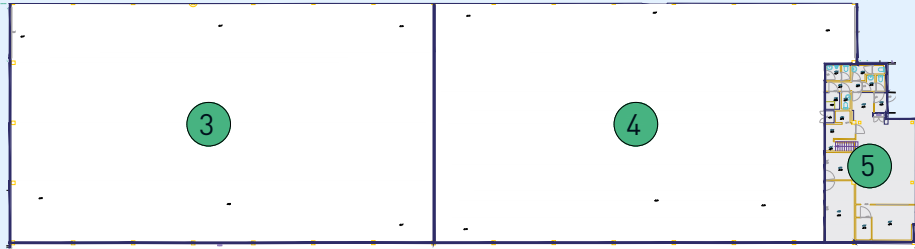

**FUNCTIONAL  
AND FLEXIBLE  
SPACE TAILORED  
FOR LOGISTICS  
OPERATIONS**



**Luithagen**

<b>Unit B</b>	(3+4+5)
Warehouse	<b>2.000 m<sup>2</sup></b>
Office	<b>250 m<sup>2</sup></b>
<b>Unit G</b>	(16+17)
Warehouse	<b>1.000 m<sup>2</sup></b>
Office	<b>225 m<sup>2</sup></b>



## Luithagen

### Unit B

Warehouse 2.000 m<sup>2</sup>

Office 250 m<sup>2</sup>

### Unit G

Warehouse 1.000 m<sup>2</sup>

Office 225 m<sup>2</sup>

# Building specifications

## Unit B

- 1 sectional gates
- Renovated offices
- LED lighting
- Parking spaces available

## Unit G

- Renovated offices
- LED lighting
- Parking spaces available



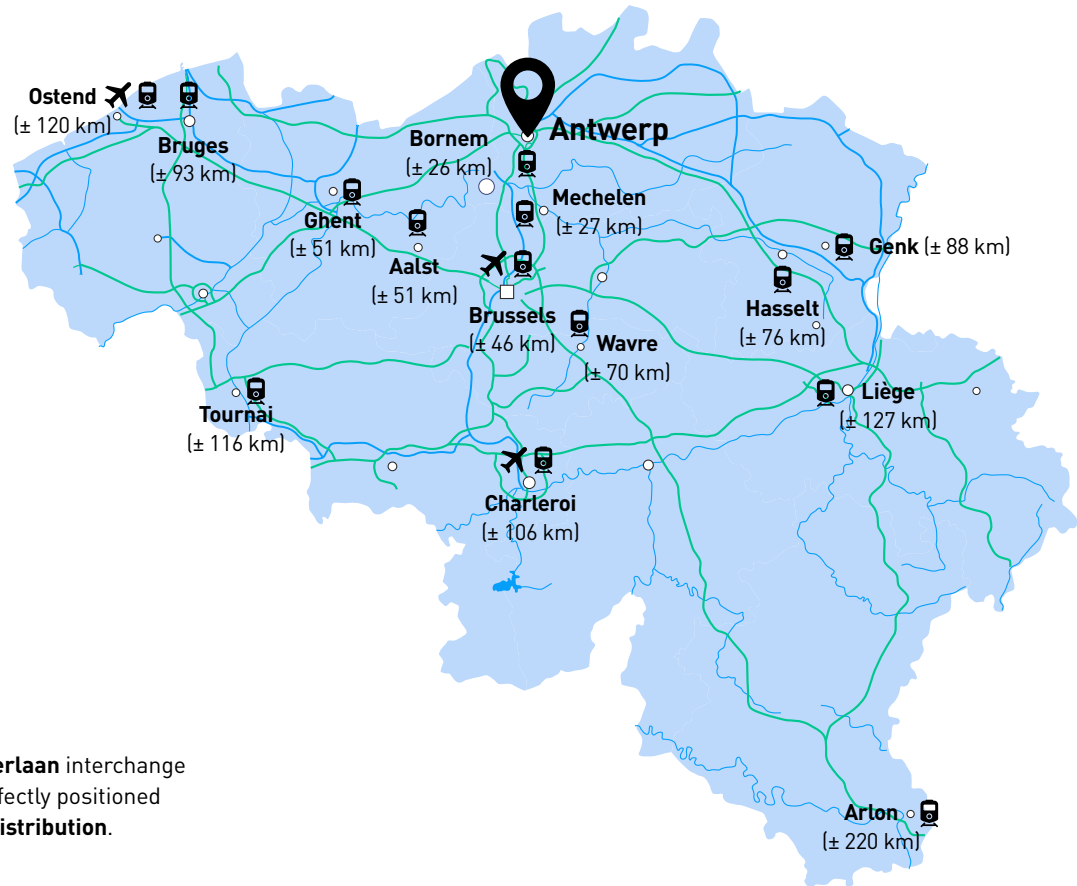

## Location

Situated at the **A12/E19/Noorderlaan** interchange —just north of the city— it's perfectly positioned for **national and international distribution**.





# IS THIS YOUR NEW SPACE FOR GROWTH ↗



Contact our Commercial Manager Belgium



**Joke Jennes**

[joke.jennes@montea.com](mailto:joke.jennes@montea.com)

+32 49 42 24 091

or visit [montea.com](https://montea.com)

SPACE FOR GROWTH ↗ SPACE FOR GROWTH ↗ SPACE FOR GROWTH ↗ SPA

## Belgium 🇧🇪

Industriezone III Zuid  
Industrielaan 27 bus 6  
BE-9320 Erembodegem  
Tel.: +32 53 82 62 62

## The Netherlands 🇳🇱

Entrada  
Ellen Pankhurststraat 1c  
NL-5032 MD Tilburg  
Tel.: +31 88 20 53 888

## Germany 🇩🇪

Mindspace (office 506)  
Neue Mainzer Straße 66-68  
60311 Frankfurt am Main  
Tel.: +49 151 424 638 11

## France 🇫🇷

48 Avenue Victor Hugo  
75016 Paris  
Tel.: +33 1 83 92 25 00

All information provided by us is without any obligation and only meant for the addressee. All information is assembled with care and in our opinion issued from a reliable source. According to the correctness we cannot, however, accept liability.